



## ASPHALT FIXING **CHEMBOLT™**



Nylon thread protector and installation plug.

**ICCONS® Chembolt™** Asphalt Fixing is an intuitive system for creating a removable or permanent fixing. Primarily designed for tarmac and asphalts, **Chembolt™** is also suitable for solid concrete substrates. **Chembolt™** does not impart stress forces to its surroundings during installation therefore is totally durable as the integrity of the substrate is left intact.

Used with **ICCONS® BIS-V**, the **Chembolt™** Asphalt Fixing provides a great solution for permanent or temporary installations and the fixing hole itself can be used many times without disturbing the anchoring, or its durability.



- Fixing point re-usable with full strength
- Fully installed in minutes
- Clean and tidy
- The solution for a temporary fixing
- Strength of tarmac & asphalt is fully maintained
- Roads, Car parks, Playgrounds, Industrial, Home.
- For use with **ICCONS® BIS-V**





General Information		Drill Dia (mm)	Hole Depth (mm)	Internal Thread Size	 qty
Carbon Steel Part #	Description				
CBA10070	M10 x 70mm asphalt fixing (08116)	14	75	M10	50
CBA10100	M10 x 100mm asphalt fixing (08117)	14	105	M10	50
CBA12070	M12 x 70mm asphalt fixing (08118)	16	75	M12	50
CBA12100	M12 x 100mm asphalt fixing (08119)	16	105	M12	50

### PERFORMANCE - when used with ICCONS® BIS-V Injection Adhesive

#### TENSION

Part #	Drill Dia (mm)	Hole Depth (mm)	Internal Thread Size	Ultimate Load Capacity (kN) in Asphalt*	Design load capacity $N_{rd}$ (kN) in 32MPa Concrete #
CBA10070	14	75	M10	Up to 10kN	21.8 kN
CBA10100		105		Up to 18kN	
CBA12070	16	75	M12	Up to 10kN	22.4 kN
CBA12100		105		Up to 18kN	

Notes : \* The above loads for Asphalt are indicative loads and depend mostly on the quality of the asphalt.

# Loads in kN for a single anchor in Non-Cracked Concrete with out edge or spacing influences. Designed for non-safety critical applications only.

#Design load capacity ( $N_{rd}$ ) incorporates safety factor  $\phi = 0.6$  concrete,  $\phi = 0.8$  steel.

Email [engineering@iccons.com.au](mailto:engineering@iccons.com.au) for further technical assistance.

### Material Specification

Product Type	Chembolt Asphalt Fixing - Threaded insert adhesive fixing
Bolt	Class 4.6
Coating	Zinc Clear

### Installation

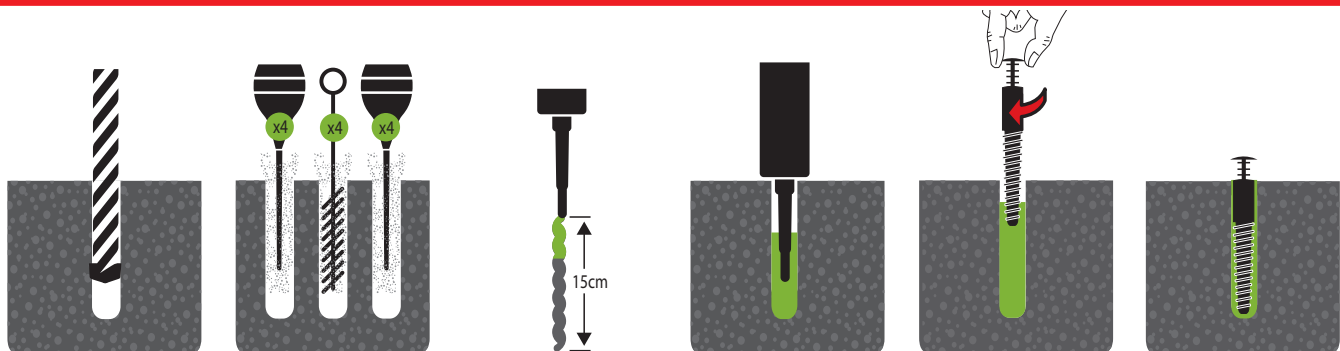

- Hole preparation should be to correct diameter and depth.
- Clean out hole thoroughly of dust and spoil by repeat blowing and brushing action.
- Unscrew Cap and screw on mixing nozzle supplied and place in suitable applicator tool.
- For new cartridges dispense a bead of adhesive until even and consistent colour is present to ensure correct mix of adhesive.
- Place nozzle to the rear of the hole and pump adhesive whilst slowly withdrawing the nozzle back, avoid creating air pockets and fill the hole at least half full.
- Install dust cap into the Chembolt.
- Push the Chembolt into the adhesive while turning one way slowly until correct embedment depth is reached and some adhesive has flowed to the top of the hole. Always ensure the Chembolt is clean and free from oil, grease and dirt.
- Wipe away any excess adhesive from the top of the anchor
- Once installed, leave dust cap inserted until ready to install bolt, do not touch or load the anchor until the adhesive is fully cured. (See appropriate adhesive label for curing times).